

1. Overview

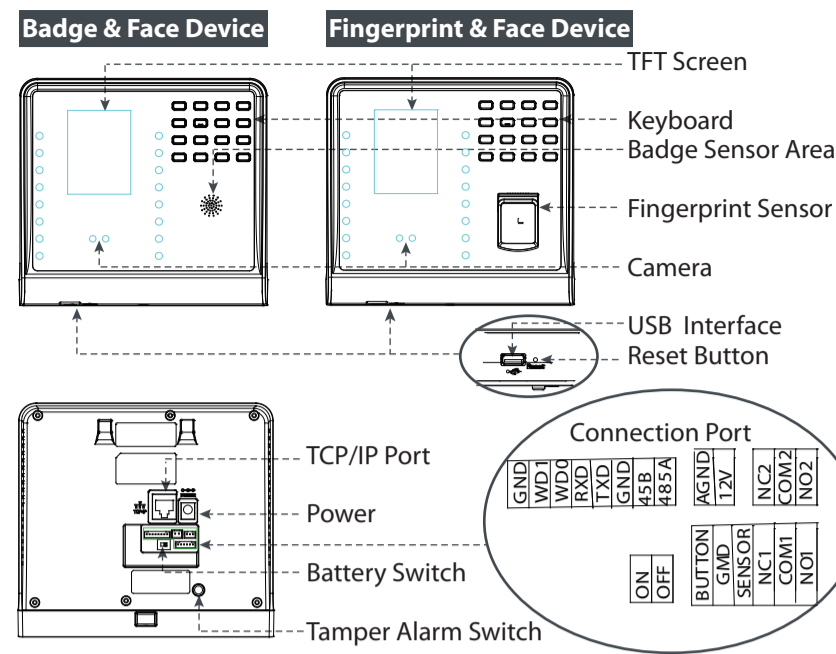

Battery Switch: Turn on the battery-powered by sliding the switch left if the wired power is not available. Slide the switch right to turn off.
 Tamper Alarm Switch: Once the tamper alarm switch pops, the system will make sound to alarm, the will be displayed in the status bar of the main interface. There will be no alarm signal while the switch is pressed.

Note: Not all the devices have the function with .

2. Installation Environment

1) Recommended Installation Location

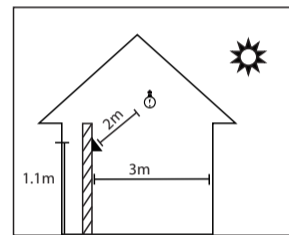

Install the device indoors at last 10 feet(3m) away from windows, and 6.5 feet (2m) from light fixtures. It is not recommended to be installed in the windows or outdoors.

1

2) Not Recommended Locations

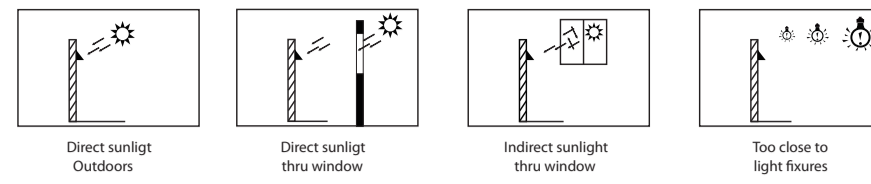

3. Installation Steps

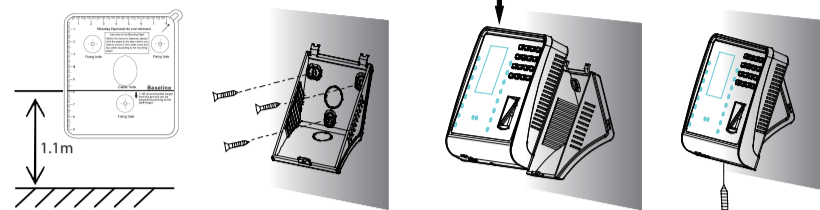

- Post the installation template on the wall and drill. The distance from baseline to the ground is 1.1m by recommendation(for height in 1.55m to 1.85m). If the distance is 1.2m, the suitable height is beyond 1.65m.
- Fix the plate with the screws on the wall.
- Updown fix the device into the plate.
- Fix the bottom screw.

4. Notifications

1) Recommended Standing Position

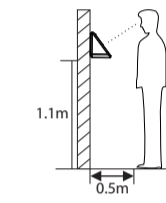

The distance from device to the user is 0.5m by recommendation(for height in 1.55m to 1.85m). It can be adjusted.

a. Recommended Method

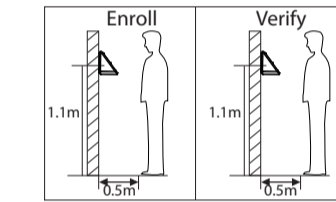

The distance from device to the user must be same while enrolling and verifying, and the distance from device to the ground must be same while enrolling and verifying.

2

b. Bad Methods

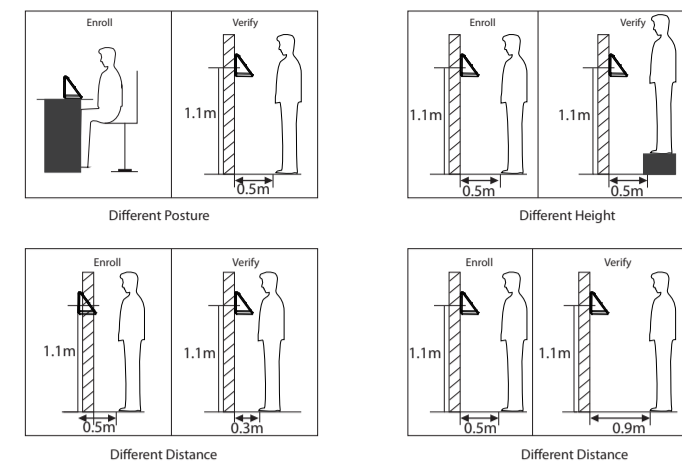

Note: Please keep natural posture and expression while enrolling and verifying.

2) Enrolling Expressions

- Please adjust your eyes into the green box by moving forward or backward while enrolling.



- Please adjust your face into the green box to make it in the screen center.



5. Quick Flows

Enroll Administrator and Users → Communication Settings → Punch/Verify → View Records

1) Enroll Administrator and Users

3

a. Enroll Administrator(Main Menu→User Management→New User)

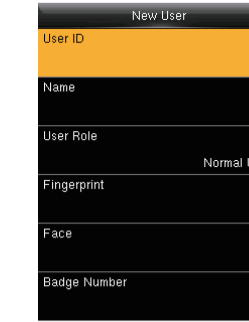

User ID: Enroll user ID, supports 1-9 digit of numbers.
 Name: Enroll name, supports 1-12 digit of any characters.
 Use Role: Select the user role between Normal User and Super Admin.
 Fingerprint : Enroll a Fingerprint or fingerprints.
 Face: Enroll a Face according to the prompts of screen and voice.
 Badge Number : Enroll a badge by swiping a badge.
 Password: Enroll the password, supports 1-9 digit of numbers.
 User Photo: Enroll the user photo which will be displayed after verifying.
 Access Control Role: Set the Access Control parameters of a user.

There are explanations about Access Control Setting(Main Menu→Access Control):

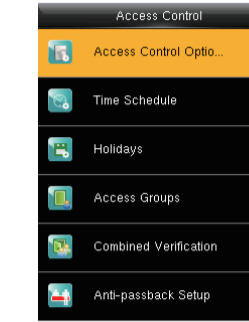

Access Control Options: Including Door Lock Delay, Door Sensor Delay, Door Sensor Type, Door Alarm Delay, Retry Times to Alarm, NC / NO Time Period etc.
 Time Schedule: Schedule Doors' opening time, 50 time zones are available to define.
 Holidays: Set special time zones for holidays.
 Access Groups: Set to manage employees in groups.
 Combined Verification: Make various groups into different access to achieve multi-verification.
 Anti-passback Setup: Set Anti-passback direction and device status.
 Duress Options: Set duress function options.

- Enroll Normal Users (same steps with enrolling administrator except the "User Role" option.)

2) Communication Settings(Main Menu→Communication)

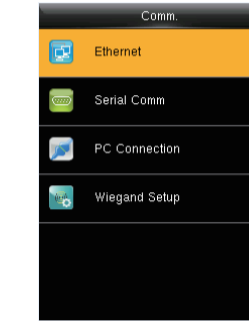

Ethernet: The device can communicate with PC via the Ethernet parameters.
 Serial Comm: The device can communicate with PC via the serial port parameters you set.
 PC Connection: Set the password and device ID so that you can connect the device with software in PC.
 Wiegand Setup: Set Wiegand-out parameters.

3) Punch and Verification

- 1:1 Fingerprint verification mode
 The device compares current fingerprint with one user's fingerprints whose ID is entered. Users choose this mode unless poor recognition.
 Enter User ID and press "fingerprint", there are two responses after verification: Successfully verified and Failed to verify.

4

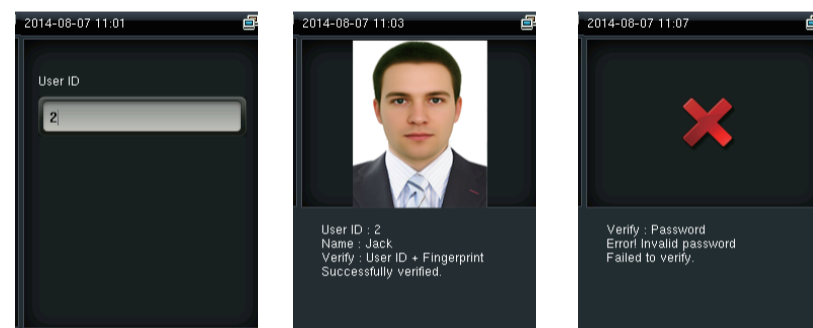

- 1:1 Face verification mode
 The device compares current face with one user's face whose ID is entered. Enter User ID and press "Face".

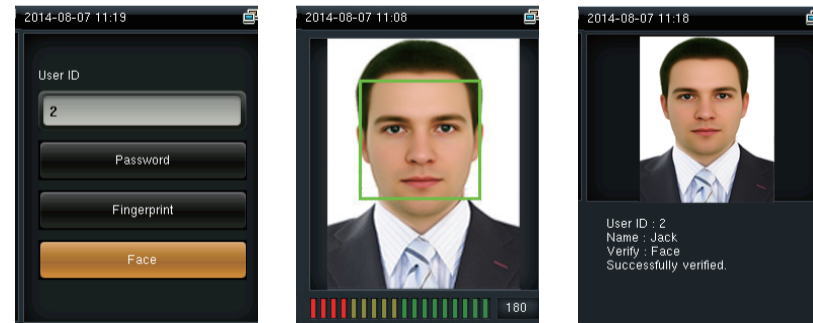

- Password Verification
 The device compares entered password with one user's password whose ID is input. Enter user ID, press "Password" and enter your password. There are two responses after verification:

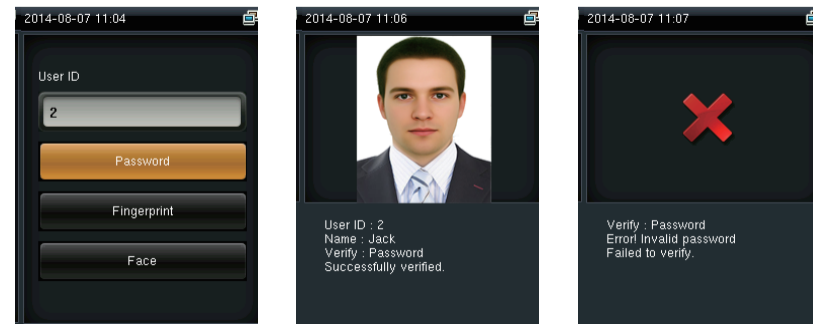

- Badge Verification
 Swipe your registered badge surround the fingerprint sensor in standby mode. The device prompts "Duplicated Punch" when you swipe badge successfully twice. The device prompts "Ou-Ou" when the badge is unregistered.

5

4) View Attendance Records

- View records in the device(Main Menu→Attendance Search→Attendance Records)

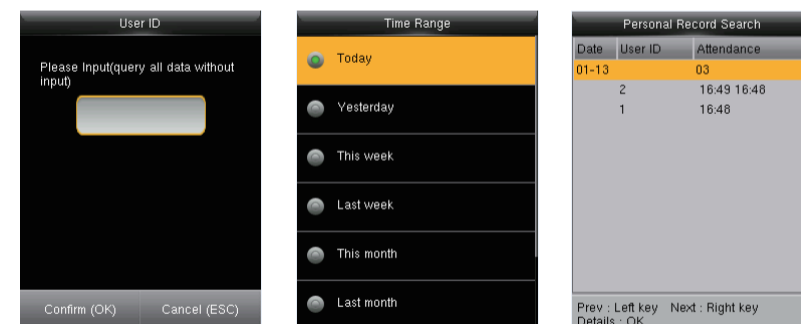

- View records on computer(Main Menu→USB Manager→Download→Attendance Data)

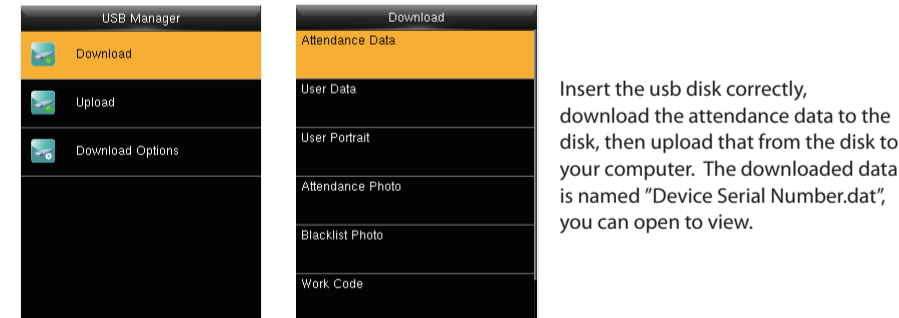

Insert the usb disk correctly, download the attendance data to the disk, then upload that from the disk to your computer. The downloaded data is named "Device Serial Number.dat", you can open to view.

6. Backup Data

To avoid deleting data by misoperation, you can backup data to local or usb disk at any time. Enter into Main Menu→Data Management→Backup Data, select the saving type and data type/types to backup.

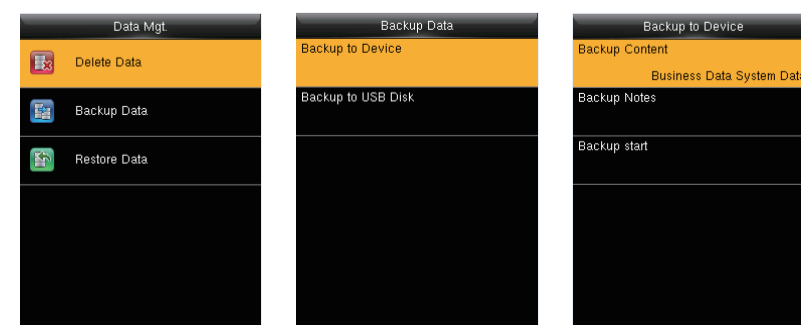

6

7. Other Settings

- Date Time (System→Date Time)
- Work Code(Work Code→New Work Code)

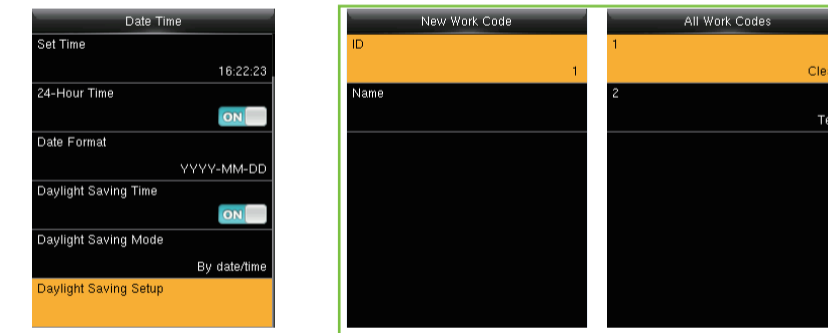

- Short Message (Short Message→New Message)

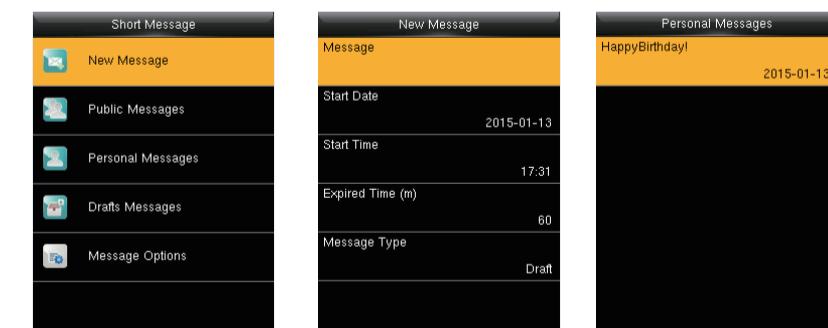

8. Problems & Solutions

- The face is not recognized by the device while verification.

Solutions:

- Check out if the expressions or standing postures and distance is same in enrolling and verifying.
- Check out if the sunlight is direct to the device or if the device is near to the windows.

- User do not wear glasses in enrolling and wear glasses in verifying.

Solution: You can enroll face wearing glasses during the first or second catching face for the device supports 3 times to catch the face templates.

- The device make a misjudgment while verification.

Solution: There is a certain probability of misjudgment, you can re-enroll the face.

7

Quick Start Guide

2.8 inches Color Screen Facial Recognition Series

Version: 1. 0