

ProCapture-WP

Water-Proof Fingerprint Access Control Terminal



ProCapture-WP is an access control terminal applying the most advanced Z-ID fingerprint sensor. Its outstanding performance provides a high identification rate towards dry, wet and rough fingers .

The fingerprint verification speed has been dramatically increased by its optimized fingerprint algorithm and the brand new ZMM220 hardware platform, equipped with a fast 1.2GHz processor.

The touch keypad delivers a smooth and easy user operation to enroll and delete users, set device and access control parameters, etc.

With its IP65 rated waterproof and dustproof structure, ProCapture-WP offers extra durability in harsh conditions such as outdoor environments. It is specially designed for standalone applications such as house, office, shop, garage, factory and others.

Features

- Modern Design & Interactive UI
- Revolutionary Z-ID Fingerprint Sensor
- Multiple Verification Modes: Fingerprint / Card / Password
- Outstanding Performance With Dry, Wet and Rough Fingers
- WaterProof IP65 Rate

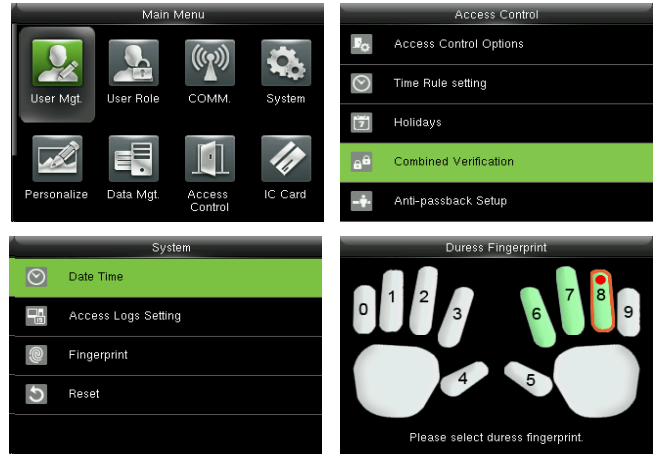

Specifications (G: GL Exclusive Feature)

Capacity

Fingerprint	20,000
Card	10,000
Transaction	100,000

Communication

- (G) TCP/IP
- (G) RS485 (For Slave Reader)
- Wiegand Input / Output
- Security Relay Box

Access Control Interface

- Lock Relay Output
- Alarm Output / Auxiliary Input
- Exit Button / Door Sensor
- Doorbell Output

(G) Dust Proof and Waterproof

Rating: IP65

Hardware

- (G) 1.2GHz High Speed CPU
- (G) Memory 128MB RAM / 256MB Flash
- Z-ID Fingerprint Sensor
- 2.4 Inches TFT-LCD Screen
- 125KHz EM Reader / IC Card (Optional)
- Hi-Fi Voice & Indicator
- Anti-dismantle Alarm
- (G) Touch Keypad

Standard Functions

- Access Levels / Groups / Holidays
- DST / Bell Schedule
- Duress Mode
- Anti-Passback
- Record Query
- Custom Wallpaper & Screen Saver

Special Functions

- (G) Multiple Verification Modes
- ZK Encrypted Card (Optional)
- (G) Fingerprint Card (Optional)

Compatibility

- Wiegand Slave Reader
- (G) RS485 FP Slave Reader
- ZKBioSecurity Software

Additional Info

Working Temperature: -10 °C ~ 50 °C
 Dimensions: 202.30x96.80x35.00mm.
 Fingerprint Algorithm ZKFinger v10.0
 Fingerprint: FAR≤0.0001% FRR≤0.01%
 Package Includes 12V 3A Power Supply

Power

Operating Voltage 12V DC
 Current Draw < 500mA

Configuration

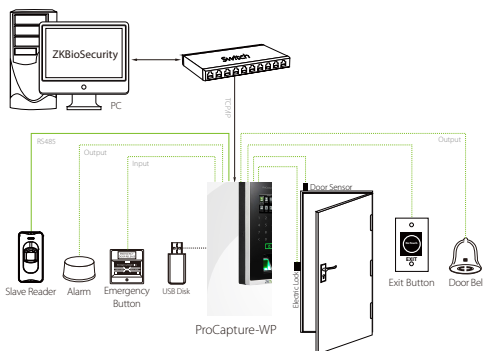

Dimensions (mm)

