



VF780

Multi-function Face Identification Terminal

VF780 is a face identification time&attendance and access control terminal, which can connect with 3rd party electric lock,door sensor and exit button etc. With the latest face identification algorithm and streamlined technology. It can hold 3000 face templates without dividing into groups. Communicating via Wi-Fi, Ethernet and USB(host), it ensures a smooth connection and data transfer. Amazing verification speed and intuitive operation process make it popular. Elaborately designed and finely processed, it match your slap-up office perfectly.

Features

- Elegant ergonomic design
- Wi-Fi,Ethernet and USB host communication
- Professional ZKTeco face identification connection
- 3000 face capacity
- 2.8 inch capacitive touch screen
- Optional IC Card module
- Infra-red optical system enables user-identifications in a wide range of light environment

Specifications

Display	2.8 inch capacitive touch screen
Face Capacity	3,000
Card Capacity	50,000/100,000(Optional)
Logs Capacity	100W
Communication	TCP/IP, USB host, Wi-Fi (Optional)
Standard Function	ID card, Automatic Status Switch, Self-Service Query, Work Code, T9 Input, 9 Digit User Id, DST, Scheduled-bell and Short Message, 3rd party electric lock, door sensor, and exit button, alarm
Optional Function	IC Card,ADMS,WiFi
Power Supply	12V/1.5A
Verification Speed	≤1S
Operating Temperature	0-45°C
Operating Humidity	20%-80%
Dimensions	106×160×36mm(L×H×D)

Configuration

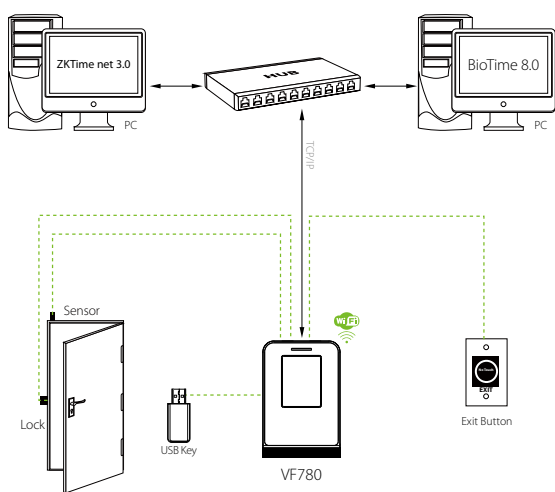

What's in the Box

