

# SCR100

## IP Based RFID Access Controller Reader

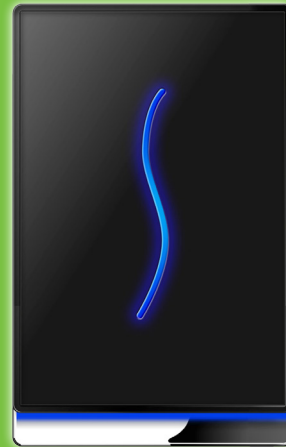

SCR100 is an access control devices produced by ZKTeco, which is made with elegant design and professional surface treatment. The device have lock control, alarm, exit button, door sensor. The wiegand-in interface is used to connect external reader to construct master and slave system. Also the device can be used to connect with a control panel as a reader by wiegand-out interface. The operation can be done on PC software and upload to the device through TCP/IP, RS232/485 communication. The USB-host is used for data download and upload, including user data and record etc.

SCR100 is suitable for house, small office and factory etc.

---

### Features

- Elegant casing design
- Easy installation, safe and reliable
- Simple and convenient operation method
- ID card standard, Mifare card optional
- Full door lock control system
- Wiegand out to connect with control panel
- Wiegand in to construct master and slave system
- Audio prompt and LED feedback guide the user to operate

# Specifications

|                              |   |
|------------------------------|---|
| ID card Capacity             | 30000,  |
| Transaction Capacity         | 50,000  |
| Communication                | TCP/IP, RS232/485, USB-Host   |
| Access Control Interface for | 3rd party electric lock, door sensor, exit button, alarm, Door Bell |
| Wiegand Signal               | Output & Input  |
| Standard Functions           | Anti-passback, Webserver, 9 digital number                          |
| Optional Functions           | Mifare  |
| Power Supply                 | 12V DC  |
| Operating Temperature        | 0 °C- 45 °C   |
| Operating Humidity           | 20%-80%   |
| Dimension(W×H×D)mm           | 153×95.5×35.5   |
| Gross Weight                 | 0.8kg   |

## Configuration

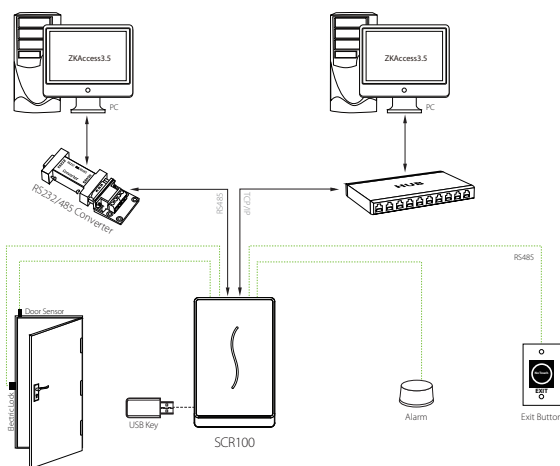

## Dimensions (mm)

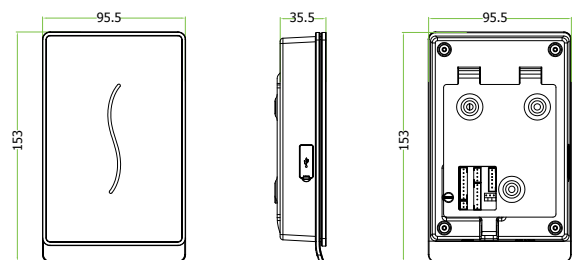

ZKTeco Middle East  
 E-mail: [zk\\_me@zkteco.com](mailto:zk_me@zkteco.com)  
[www.zkteco.com](http://www.zkteco.com)