



# SF101

## Fingerprint Access Control System with Metallic Housing

SF101 is an access control device produced by ZKTeco, which is made with Zinc Alloy with elegant design and professional surface treatment. The device can work as a standalone access control or wiegand reader. The device have lock control, alarm, exit button, door sensor and wiegand out.

SF101 has three buttons including enroll, delete and door bell. The operation with audio prompt is convenient for the user. Also the system administrator can use RS232/485 or USB client to manage the device from PC by software. The cover on the sensor can protect the device from dust and water.

SF101 is applicable for small office, house, and factory as a standalone access control system or for airport, data center as a biometric wiegand reader.

---

### Features

- Metallic Casing
- Easy installation, safe and reliable
- The cover protect the fingerprint sensor from dust and water
- Simple and convenient operation method with full audio prompt
- Elegant fingerprint sensor
- ID card standard, Mifare card optional
- Full door lock control system
- Wiegand out to connect with control panel
- Audio prompt guide the user to operate

# Specifications

Fingerprint Capacity	200 templates
ID card Capacity	100
Transaction Capacity	30,000
Sensor	ZK Optical Sensor
Communication	RS232/485, USB-client
Access Control Interface fo	3rd party electric lock, door sensor, exit button, alarm, Door Bell
Wiegand Signal	Output
Optional Functions	Mifare
Power Supply	12V DC
Operating Temperature	0 °C- 45 °C
Operating Humidity	20%-80%
Dimension(W×H×D)mm	120×120×35
Gross Weight	0.9KG

## Configuration

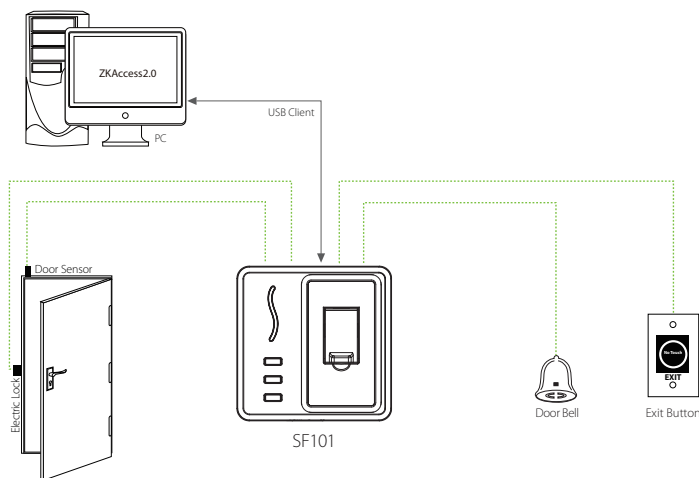

## Dimensions (mm)

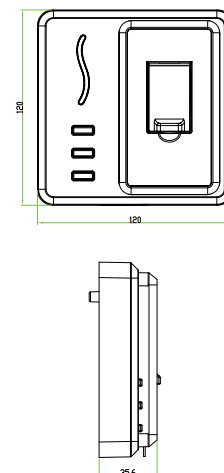

ZKTeco Middle East  
 E-mail: [zk\\_me@zkteco.com](mailto:zk_me@zkteco.com)  
[www.zkteco.me](http://www.zkteco.me)