

G3-H

Multi-Biometric Smart Identification Terminal



G3-H is a multi-biometric identification terminal which features ZKTeco's innovation Silk ID fingerprint sensor technology. With the world's cutting-edge 3D Neuron Fingerprint Algorithm, it precisely authenticates dry, wet, or rough fingerprints efficiently and accurately. Infrared technology enables the device to function automatically when fingerprints are detected. With the latest facial algorithm, it supports color photos detection and prevents repeated face registration.

G3-H also comes with hardware promoted, it supports huge capacity of facial and fingerprint users, maximum upto 50,000 users and 1,000,000 transactions.

Features



Modern Design & Interactive UI



Revolutionary SilkID Fingerprint Sensor



Multiple Verification Modes: Face / Fingerprint / Card / Password



Outstanding Performance With Dry, Wet and Rough Fingers



Simple Management & Scalability

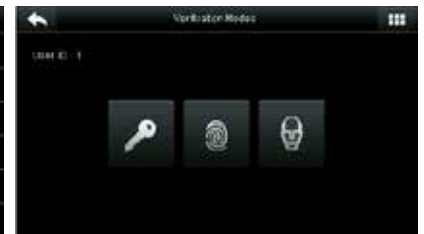

Specifications (G: GL Exclusive Feature)

Capacity

Standard

| | |
|--------------|------------------------|
| Fingerprints | 10,000(1:N) |
| Faces | 3,000(1:N) 10,000(1:1) |
| Cards | 10,000 |
| Transactions | 1000,000 |

Optional

| | |
|--------------|------------------------|
| Fingerprints | 50,000(1:N) |
| Faces | 3,000(1:N) 30,000(1:1) |
| Cards | 50,000 |
| Transactions | 1000,000 |

Communication

TCP / IP / USB Host / Wiegand Output

Access Control Interface

Lock Relay Output / Alarm Output / Exit Button / Door Sensor/ External Bell

Hardware

- G 1.2GHz CPU
- G Memory 1GB RAM / 1GB Flash
- G SilkID Fingerprint Sensor
- G 4.3 Inches Touch Screen
- Hi-Fi Voice & Indicator
- Tamper Switch Alarm

Standard Functions

ID Card / Work Code / ADMS
DST / SMS / Bell Schedule
Attendance Status Auto-Switch
Record Query / Photo ID Custom
Wallpaper & Screen Saver

Special Functions

- G Multiple Biometric Verification Modes
- G Alive Finger Detection
- G Duplicate Face Detection

Optional Functions

- HID Proxy / Mifare Card Reader
- G Wi-Fi / 3G
- External Printer
- G Battery (2,000 mAh)
- G POE(Standard IEEE 802.3at)

Compatibility

BioTime 7.0

Additional Info

Working Temperature: 0 °C ~ 45 °C
Dimensions: 199.2 × 171.8 × 96.9 mm
ZKFace v7.0 & ZKFinger v10.0 Algorithms
Fingerprint: FAR≤0.0001% FRR≤0.01%
Face: FAR≤0.001% FRR≤1%

Power

Operating Voltage 12V DC
Current Draw < 500 mA

Configuration

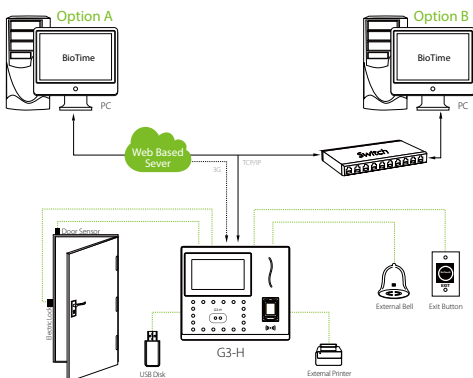

Dimensions (mm)

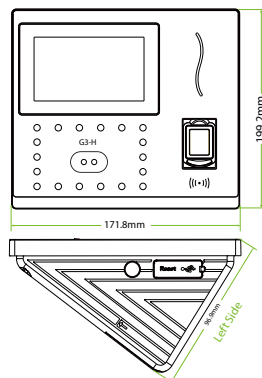

ZKTECO Middle East
www.zkteco.me
E-mail: zk_me@zkteco.com



© Copyright 2018. ZKTECO CO.,LTD. ZKTECO Logo is a registered trademark of ZKTECO or a related company. All other product and company names mentioned are used for identification purposes only and may be the trademarks of their respective owners. All specifications are subject to change without notice. All rights reserved.