

P200 & P260

Palm Recognition Multi-Biometric T&A Terminal with Access Control Functions



P serial is a multi-biometric identification time & attendance and access control terminal, which can connect with third party electric lock, door sensor, and exit button etc.

With the latest palm/fingerprint identification algorithm and streamlined technology, it can hold 600 palm templates and up to 10,000 fingerprint templates without dividing into groups.

Communicating via Wi-Fi, TCP/IP, and USB host, it ensures a smooth connection and data transfer. Amazing verification speed and intuitive operation process make it popular. Elaborately designed and finely processed, it matches your slap-up office perfectly.

Features



Build in PoE



1 channel auxiliary input for smoke detector connection



Build in battery, up to 4 hours



Multiple communicate mode, Wi-Fi, TCP/IP, 3G, USB host



Stable operation under strong light source



Advance access function including lock connection, alarm, wiegand input and output



600 Palms, 3,000 Fingerprints,
10000 ID Cards and 100,000 records

Specifications

Product	P200		P260
Main	Biometric	Fingerprint and Palm	
	RF Optional	125kHz EM/13.56MHz MF	
Capacity	Max User(1:N)	10,000	
	Max Fingerprint (1:N)	3,000 standard/10,000 Optional	
	Max Palm (1:N)	600	
Interface	TCP/IP	10/100 M	
	PoE Optional	802.3 at 28W	
	Wi-Fi	802.11 B/G/N	
	3G Optional	WCDMA	
	USB	USB 2.0 (Host)	
	RS232	1 port for external printer	
	RS485	1 port for FP reader	
	Relay	2 relays	
	Wiegand	1ch In & Out	
Hardware	Input	1 Input	
	LCD	2.8" Color LCD	
	Sound	24-bit	
	Operating Temp.	0 °C- 45 °C	
	Operating Humidity	20% ~ 80%	
	Power	DC 12V 1.5A	DC 12V 3A
	Dimensions(W x H x D mm)	213*155*107.81mm	
Certificates	CE, FCC, RoHS		
Function	Standard	Automatic Status Switch, Self-Service Query, DST, T9 Input, 9 Digit User ID, Scheduled Bell, Photo ID Lock, sensor, Exit button, ADMS	
	Optional	ID/MF	
Compatibility	BioTime software		

Configuration

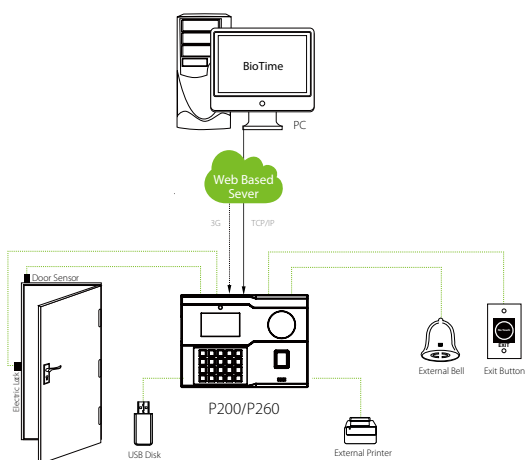

Dimensions (mm)

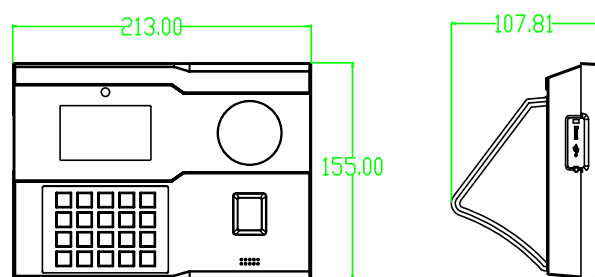

ZKTECO CO.,LTD.
E-mail: zk_me@zkteco.com
www.zkteco.me

© Copyright 2017. ZKTECO CO.,LTD. ZKTeco Logo is a registered trademark of ZKTeco or a related company. All other product and company names mentioned are used for identification purposes only and may be the trademarks of their respective owners. All specifications are subject to change without notice. All rights reserved.

