

ProCapture-WP

Water-Proof Fingerprint Access Control Terminal



ProCapture-WP is an access control terminal applying the most advanced BiOD fingerprint sensor. Its outstanding performance provides a high identification rate towards dry, wet and rough fingers .

The fingerprint verification speed has been dramatically increased by its optimized fingerprint algorithm and the brand new ZMM220 hardware platform, equipped with a fast 1.2GHz processor.

The touch keypad delivers a smooth and easy user operation to enroll and delete users, set device and access control parameters, etc.

With its IP65 rated waterproof and dustproof structure, ProCapture-WP offers extra durability in harsh conditions such as outdoor environments. It is specially designed for standalone applications such as house, office, shop, garage, factory and others.

Features



Modern Design & Interactive UI



Revolutionary BioID Fingerprint Sensor



Multiple Verification Modes: Fingerprint / Card / Password



Outstanding Performance With Dry, Wet and Rough Fingers



WaterProof
IP65 Rate

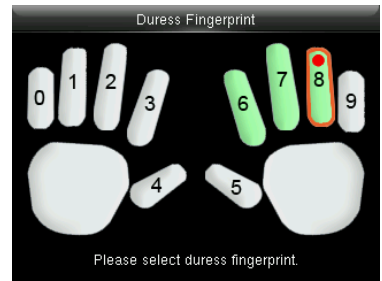
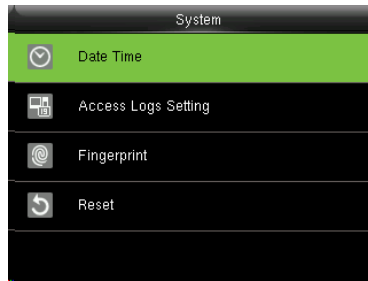
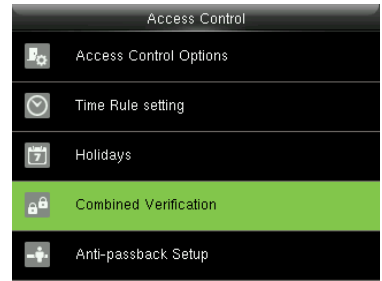

Specifications (G): GL Exclusive Feature

Capacity

Fingerprint	20,000
Card	10,000
Transaction	100,000

Communication

- (G) TCP/IP
- (G) RS485 (For Slave Reader)
- Wiegand Input / Output
- Security Relay Box

Access Control Interface

- Lock Relay Output
- Alarm Output / Auxiliary Input
- Exit Button / Door Sensor
- Doorbell Output

Hardware

- (G) 1.2GHz High Speed CPU
- (G) Memory 128MB RAM / 256MB Flash
- BioID Fingerprint Sensor
- 2.4 Inches TFT-LCD Screen
- 125KHz EM Reader / Mifare (Optional)
- Hi-Fi Voice & Indicator
- Anti-dismantle Alarm
- (G) Touch Keypad

Standard Functions

- Access Levels / Groups / Holidays
- DST / Bell Schedule
- Duress Mode
- Anti-Passback
- Record Query
- Custom Wallpaper & Screen Saver

Special Functions

- (G) Multiple Verification Modes
- ZK Encrypted Card (Optional)
- (G) Fingerprint Card (Optional)

Compatibility

- Wiegand Slave Reader
- (G) RS485 FP Slave Reader
- ZKBioSecurity Software

Additional Info

- Working Temperature: -10 °C ~ 50 °C
- Dimensions: 202.30x96.80x35.00mm.
- Fingerprint Algorithm ZKFinger v1.0.0
- Fingerprint: FAR≤0.0001% FRR≤0.01%
- Package Includes 12V 3A Power Supply

Power

- Operating Voltage 12V DC
- Current Draw < 500mA

Configuration

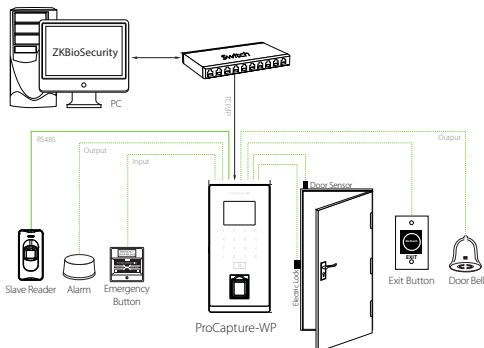

Dimensions (mm)

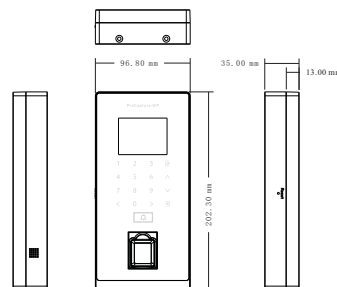

ZKTeco Inc.

www.zkteco.com

E-mail: sales@zkteco.com



© Copyright 2017, ZKTECO CO.,LTD. ZKTeco Logo is a registered trademark of ZKTeco or a related company. All other product and company names mentioned are used for identification purposes only and may be the trademarks of their respective owners. All specifications are subject to change without notice. All rights reserved.