

BioPro ST40

Fingerprint Recognition Time and Attendance Terminal



BioPro ST40 is a fingerprint identification time and attendance terminal, which can connect with third party electric lock, door sensor and exit button etc.

Communicating via Wi-Fi, TCP/IP, 3G and USB host, it ensures a smooth connection and data transfer.

It's associated with new ZK fingerprint reader, the operation remains stable under strong light source and high preciseness of verification of wet and rough fingers. Amazing verification speed and intuitive operation process make it popular. It will match your slap-up office perfectly.

Features



Built in PoE



1 channel auxiliary input for smoke detector connection



Built in battery, up to 4 hours



Multiple communicate mode:
Wi-Fi, TCP/IP, 3G, USB host



Stable operation under strong
light source

Specifications

Main	Biometric	Fingerprint
	RF Optional	125kHz EM / 13.56MHz MF
Capacity	Max User(1:N)	10,000
	Max Fingerprint (1:N)	3,000 standard / 10,000 Optional
	Max Record	100,000
Interface	TCP/IP	10/100 M
	PoE (Optional)	802.3 at 28W
	Wi-Fi	802.11 B/G/N
	3G (Optional)	WCDMA
	USB	USB 2.0 (Host)
	RS232	1 port for external printer
Hardware	LCD	2.8" Color LCD
	Sound	24-bit
	Operating Temp.	0 °C - 45 °C
	Operating Humidity	20% ~ 80%
	Power	DC 12V 1.5A
	Dimensions(W x H x D mm)	213*155*107.81 mm
	Certificates	CE, FCC, RoHS
Function	Standard	Automatic Status Switch, Self-Service Query, DST, T9 Input, 9 Digit User ID, Scheduled Bell, Photo ID, Lock, sensor, Exit button, ADMS
	Optional	ID / Mifare
Compatibility	Software	BioTime 7.0

Configuration

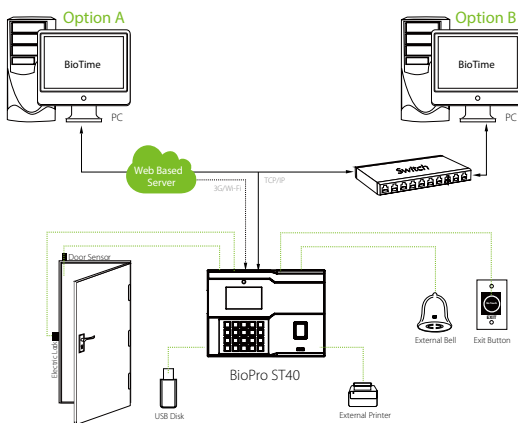

Dimensions (mm)

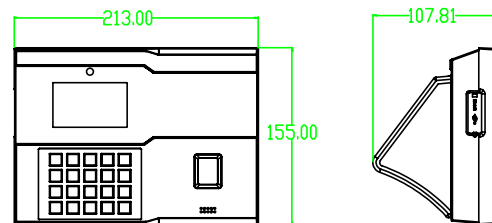

ZKTeco Middle East
 E-mail: zk_me@zkteco.com
www.zkteco.me

© Copyright 2017. ZKTeco CO.,LTD. ZKTeco Logo is a registered trademark of ZKTeco or a related company. All other product and company names mentioned are used for identification purposes only and may be the trademarks of their respective owners. All specifications are subject to change without notice. All rights reserved.

