



# Horus

## Wireless Facial Recognition Terminal

The trend of Visible Light Facial Recognition technology have brought user experience of biometric technology to a new height. As one of the biometric industry leaders, ZKTeco launched the second-generation facial recognition terminal—Horus series, named after an Egyptian god, who has the legendary “all-seeing eye” that can clearly observe everything. Horus is one of the most advanced Access Control & time and attendance terminal existing in the market, with incredibly compact size (almost the same size as iPhone XS max) and powerful facial recognition technology offering up to 3 meters recognition distance,  $\pm 30$  degree pose angle tolerance, high anti-spoof ability, support on plentiful communication protocols (Wi-Fi, 3G, 4G, Bluetooth) and worldwide network setting, optional fingerprint and RFID card modules, up to 10,000 facial templates capacity, and is compatible with the all-in-one security & time attendance platform ZKBioSecurity and BioTime.

### Features

- New height of facial recognition template capacity up to 1: N-10,000 facial templates.
- Anti-spoofing algorithm against print attack (laser, color and B / W photos), videos attack, and 3D mask attack.
- Supports multiple communication protocols: 4G, Wi-Fi, Bluetooth and USB.
- 5-inch smartphone grade IPS touch LCD monitor
- Extensive Fingerprint, RFID, TCP / IP, modules available.
- Extra-large 2MP CMOS with WDR function
- Various further development options: embedded GPS / A-GPS, microphone and PIR sensor

# Specifications

|                              | Horus E1   | Horus E1-RFID   | Horus E1-FP   |
|------------------------------|--|---|---|
| Picture                      |   |  |  |
| CPU                          | Quad-core, 1.5GHz  |   |   |
| Android Version              | Android 8.1  |   |   |
| Memory                       | RAM 2GB / ROM 16GB   |   |   |
| Camera                       | 2MP Dual Camera  |   |   |
| LCD                          | 720*1280, IPS touch LCD  |   |   |
| Verification Mode            | Face   | Face + RFID   | Face + Fingerprint + RFID   |
| Face Capacity                | 6,000 / 10,000 (optional)  |   |   |
| Fingerprint Capacity         | N / A  | N / A   | 6,000 / 10,000 (optional)   |
| ID Card / MF Card            | N / A  | 10,000  |   |
| Access Control (DM10 Module) | N / A  | 10,000 (optional)   |   |
| TCP/IP                       | N / A  | 10 / 100 Mbps   |   |
| Wi-Fi                        | 2.4GHz, 5GHz, 802.11a / b / g / n  |   |   |
| Bluetooth                    | 4.0  |   |   |
| 4G Wireless Broadband        | GSM: B2 / B3 / B5 / B8<br>WCDMA: B1 / B2 / B4 / B5 / B8<br>TDD-LTE: B38 / B40 / B41M<br>FDD-LTE: B1 / B2 / B3 / B4 / B5 / B7 / B8 / B12 / B17 / B20 / B28A / B28B' |   |   |
| USB                          | USB 3.0  |   |   |
| GPS                          | GPS / A-GPS  |   |   |
| Speaker                      | 90DB (10cm distance)   |   |   |
| Microphone                   | 1m clear voice pickup  |   |   |
| Dimensions                   | 158 * 74 * 15.6mm  | 205.33 * 74 * 17.7 mm   |   |
| Power                        | 12V 2A   |   |   |
| Operating Temperature        | -10℃ — 50℃   |   |   |
| Operating Humidity           | 20% — 80%RH  |   |   |
| Certifications               | CE, FCC, RoHS  |   |   |

## Configuration

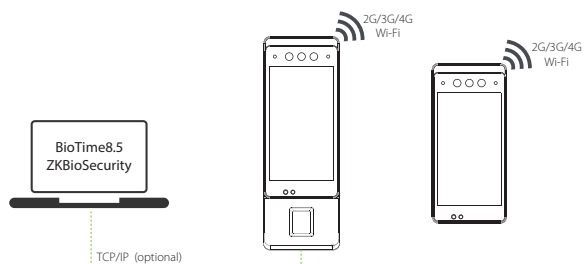

## Dimensions (mm)

