

ProCapture-T

Fingerprint Access Control Terminal



ProCapture-T is an access control terminal applying the most advanced SilkID fingerprint sensor. Its outstanding performance provides a high identification rate towards dry, wet and rough fingers, being capable to detect alive finger for a higher security level.

The fingerprint verification speed has been dramatically increased by its optimized fingerprint algorithm and the brand new ZMM220 hardware platform, equipped with a fast 1.2GHz processor.

The touch keypad delivers a smooth and easy user operation to enroll and delete users, set device and access control parameters, etc.

Its built-in camera allows to capture user's photos and events snapshots to provide attendance evidence (optional function).

Features



Modern Design & Interactive UI



Revolutionary SilkID Fingerprint Sensor



Multiple Verification Modes:
Fingerprint / Card / Password



Outstanding Performance With
Dry, Wet and Rough Fingers



Built In Camera
* Event Snapshot
* User Photo (Optional)

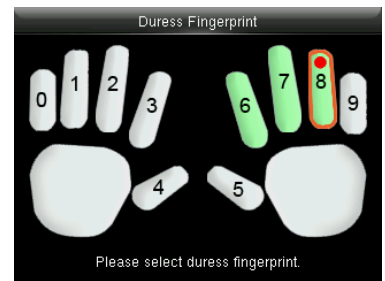
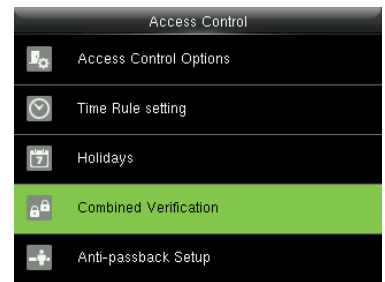
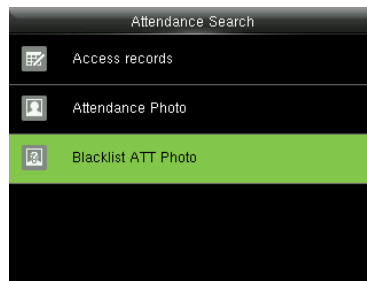

Specifications

Capacity

Fingerprint	20,000
Card	20,000
Transaction	100,000
User Photo	3,000
Event Photo	7,000

Communication

TCP/IP
RS485 (For Slave Reader)
USB Host
Wiegand Input / Output
Security Relay Box

Access Control Interface

Lock Relay Output
Alarm Output / Auxiliary Input
Exit Button / Door Sensor
Doorbell Output

Hardware

1.2GHz CPU
Memory 128MB RAM / 256MB Flash
SilkID Fingerprint Sensor
2.4 Inches TFT-LCD Screen
125KHz EM Reader / Mifare (Optional)
Hi-Fi Voice & Indicator
Tamper Switch Alarm
Touch Keypad
120° Wide Angle Camera

Standard Functions

Access Levels / Groups / Holidays
DST / Bell Schedule
Duress Mode
Anti-Passback
Record Query
Custom Wallpaper & Screen Saver

Special Functions

Multiple Verification Modes
Alive Finger Detection
Event Snapshot
User Photo (Optional)

Compatibility

Wiegand Slave Reader
RS485 FP Slave Reader
ZKBioSecurity Software

Additional Info

Working Temperature: -10 °C ~ 50 °C
Dimensions: 195.5 × 87 × 35 mm.
Fingerprint Algorithm ZKFinger v10.0

Power

Operating Voltage 12V DC
Current Draw < 500mA

Configuration

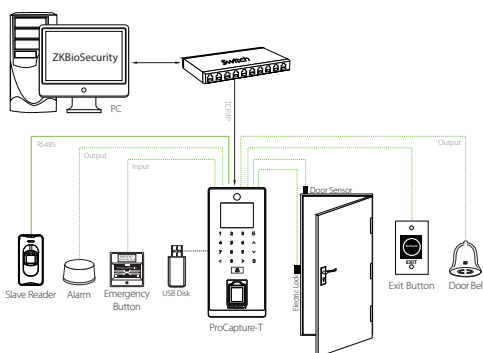

Dimensions (mm)

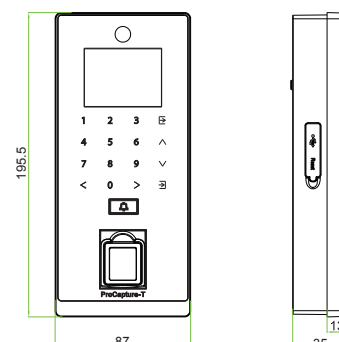

ZKTeco Inc.

www.zkteco.com

E-mail: sales@zkteco.com



© Copyright 2015, ZKTeco Inc. ZKTeco Logo is a registered trademark of ZKTeco or a related company. All other product and company names mentioned are used for identification purposes only and may be the trademarks of their respective owners. All specifications are subject to change without notice. All rights reserved.