

G1

Fingerprint Time Attendance Terminal



G1 is a revolutionary fingerprint time attendance device which incorporates the latest ZKTeco technology with completely new design. Enjoy excellent new features including Silk ID fingerprint sensor, new hardware platform, expanded fingerprint storage capacity, and more efficient and accurate verification. Infrared technology enables detection and provide higher energy efficiency.

Features



Modern Design & Interactive UI



Revolutionary SilkID Fingerprint Sensor



Multiple Verification Modes:
Fingerprint / Card / Password



Outstanding Performance With
Dry, Wet and Rough Fingers



Simple Management & Scalability

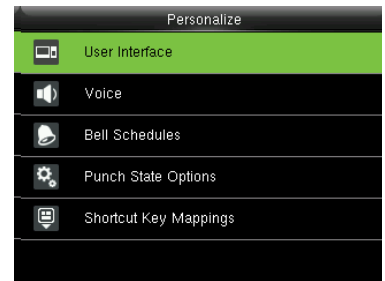
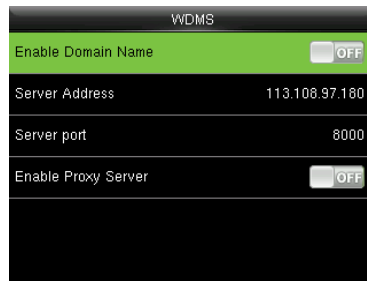

Specifications G: GL Exclusive Feature)

Capacity

Fingerprints	5,000
Cards	15,000
Transactions	100,000

Communication

TCP/IP
USB Host / Client

Hardware

- G 1.2GHz High Speed CPU
- G Memory 128MB RAM / 256MB Flash
- SilkID Fingerprint Sensor
- 2.8 Inches TFT-LCD Screen
- Hi-Fi Voice & Indicator

Standard Functions:

ID Card / Work Code / WDMS
DST / Bell Schedule / Photo ID
Attendance Status Auto-Switch
Record Query
Custom Wallpaper & Screen Saver

Optional Functions:

- G HID Proxy / Mifare Card Reader
- G Wi-Fi
- External Printer

Special Functions:

- G Multiple Verification Modes
- G Alive Finger Detection

Compatibility

ZKTime Web 3.0
ZKTime.Net 3.0
WDMS

Additional Info

Working Temperature: 0 °C ~ 45 °C
Dimensions: 190.8 × 140.1 × 46.02 mm
Fingerprint Algorithm ZKfinger v1.0.0
FAR≤0.0001% FRR≤0.01%

Power

Operating Voltage 5V DC
Current Draw < 250 mA

Configuration

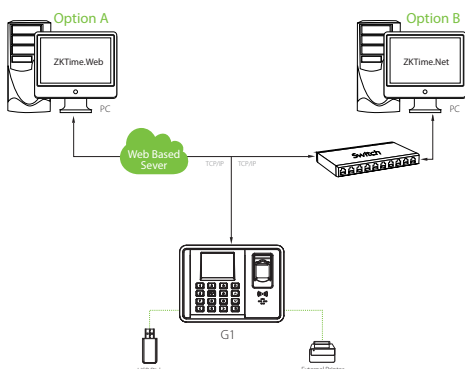

Dimensions (mm)

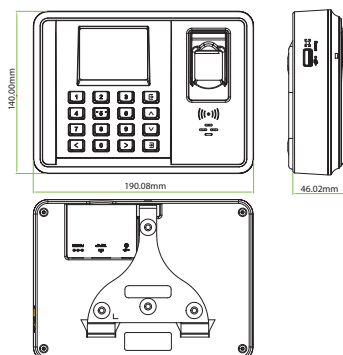

ZKTeco Middle East
www.zkteco.me
E-mail: sales@zkteco.me



© Copyright 2016, ZKTeco Inc. ZKTeco Logo is a registered trademark of ZKTeco or a related company. All other product and company names mentioned are used for identification purposes only and may be the trademarks of their respective owners. All specifications are subject to change without notice. All rights reserved.