

G3

Multi-Biometric Time Attendance & Access Control Terminal



G3 is a multi-biometric identification terminal which features ZKTeco's innovation Silk ID fingerprint sensor technology. With the world's cutting-edge 3D Neuron Fingerprint Algorithm, it precisely authenticates dry, wet, or rough fingerprints efficiently and accurately. Infrared technology enables the device to function automatically when fingerprints are detected. With the latest facial algorithm, it supports fake face detection.

Features



Modern Design & Interactive UI



Revolutionary SilkID Fingerprint Sensor



Multiple Verification Modes:
Face / Fingerprint / Card / Password



Outstanding Performance With
Dry, Wet and Rough Fingers



Simple Management & Scalability

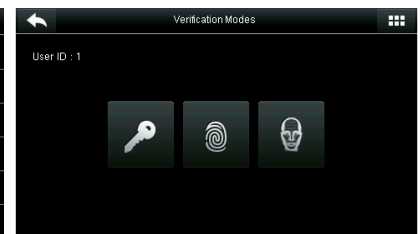
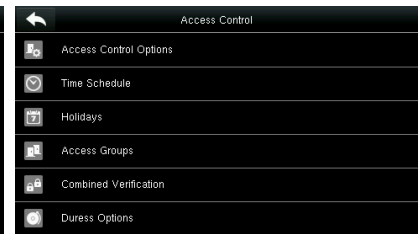
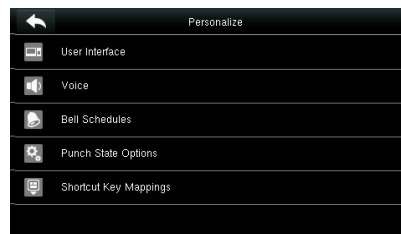

Specifications (G: GL Exclusive Feature)

Capacity

Fingerprints	5,000
Faces	3,000 (1:1) / 5,000 (1:1)
Cards (Optional)	10,000
Transactions	100,000

Communication

TCP/IP
USB Host
Wiegand Output

Access Control Interface

Lock Relay Output
Alarm Output
Exit Button
Door Sensor
External Bell

Hardware

- G 1.2GHz High Speed CPU
- G Memory 128MB RAM / 256MB Flash
- G SilkID Fingerprint Sensor
- G 4.3 Inches Touch Screen
- Hi-Fi Voice & Indicator
- Tamper Switch Alarm

Standard Functions

ID Card / Work Code / WDMS
DST / SMS / Bell Schedule
Attendance Status Auto-Switch
Record Query / Photo ID
Custom Wallpaper & Screen Saver

Special Functions

- G Multiple Biometric Verification Modes
- G Alive Finger Detection
- G Duplicate Face Detection

Optional Functions:

- HID Proxy / Mifare Card Reader
- G Wi-Fi / 3G
- External Printer
- G Battery (2,000 mAh)

Compatibility

ZKTime Web 3.0
ZKAccess 3.5
WDMS

Additional Info

Working Temperature: 0 °C ~ 45 °C
Dimensions: 199.2 × 171.8 × 96.9 mm
ZKFace v7.0 & ZKFinger v10.0 Algorithms
Fingerprint: FAR≤0.0001% FRR≤0.01%
Face: FAR≤0.001% FRR≤1%

Power

Operating Voltage 12V DC
Current Draw < 500 mA

Configuration

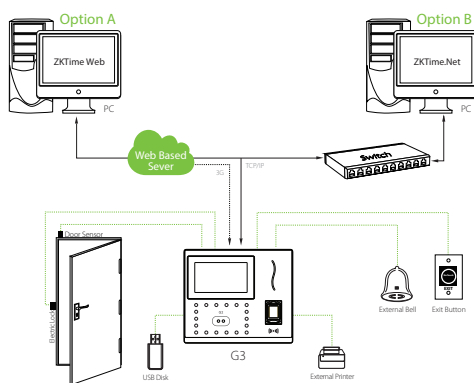

Dimensions (mm)

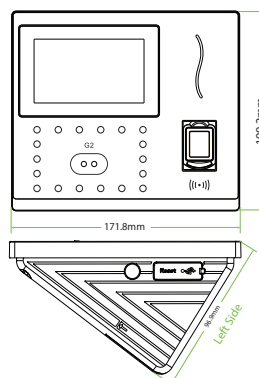

ZKTeco Middle East
www.zkteco.me
E-mail: zk_me@zkteco.com



© Copyright 2016, ZKTeco Inc. ZKTeco Logo is a registered trademark of ZKTeco or a related company. All other product and company names mentioned are used for identification purposes only and may be the trademarks of their respective owners. All specifications are subject to change without notice. All rights reserved.