

iFace950

Multi-Biometric T&A and Access Control Terminal



ZKTeco has released the iFace950 Multi-Biometric T&A and Access Control Terminal which supports 3,000 face templates, 2,000 fingerprint templates and 10,000 cards (optional). It is equipped with ZKTeco latest hardware platform and algorithm, which provide clients with a brand new UI and user-friendly operating interface, bringing them a smooth using experience. With the advanced face algorithm and multi-biometric verification technology, the terminal's security level of verification is greatly enhanced.

Features

- 3,000 face and 2,000 fingerprint templates
- Multi-languages
- High verification speed
- Advanced and user-friendly UI
- Chip encryption for firmware protection
- Optional built-in battery backup providing approximately 4 hours of continuous operation
- Easy to extend functions and customize client's requirements
- One face template is registered for one user only
- Able to detect whether the face is an actual face or a photo, enhancing the security level of verification

Specifications

Display	4.3-Inch Touch Screen
Face capacity	3, 000 (1:N)
Fingerprint capacity	2, 000
ID Card capacity	10, 000 (optional)
Logs capacity	100, 000
Communication	TCP/IP, RS232/485, USB Host
Standard Functions	Automatic Status Switch, Self-Service Query, Work Code, SMS, DST, T9 Input, 9 Digit User ID, Scheduled Bell, Photo ID
Interfaces for	3rd Party Electric Lock, Door Sensor, Exit Button, Alarm
Wiegand Signal	Output
Optional Functions	MiFare Card, ADMS, 2000 mAh Backup Battery, Wi-Fi, 3G/GPRS
Power Supply	12V 3A
Operating Temperature	0 °C- 45 °C
Operating Humidity	20%-80%
Dimensions	194.1*169*109.0mm (Length*Width*Thickness)
Package Weight	1.6 kg

Configuration

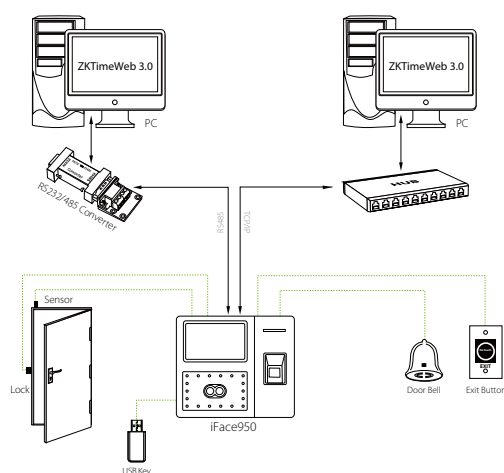

What's in the Box

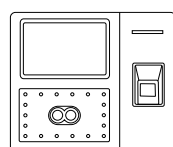

iFace950

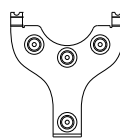

Back Plate

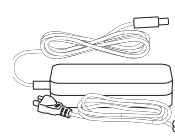

Power Adapter



Lines for Access Control Interface

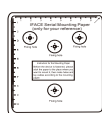

Mounting Paper



Screws and Holders



Screw Driver



Paper ruler



ZKTeco Middle East
E-mail: sales@zkteco.me
www.zkteco.me

© Copyright 2015. ZKTeco Inc. ZKTeco Logo is a registered trademark of ZKTeco or a related company. All other product and company names mentioned are used for identification purposes only and may be the trademarks of their respective owners. All specifications are subject to change without notice. All rights reserved.