

SBTL8033

Single Lane Speed Gates With Visible Light Facial Recognition Devices



SBTL 8000 is an indoor speed gates series which featured by its quick man-machine interact. Facial recognition speed is less than 0.3 sec per face. And its high opening speed provides passenger a great experience.

Facial recognition

SBTL8033 is equipped with an advanced face recognition product, ProFace X. It's powered by the latest ZKTeco-customized CPU for running the intellectualized engineering facial recognition algorithm to boost up the performance in all aspects. With its powerful core and the latest facial recognition algorithm, the ProFace X facial recognition capability has reached a new height in the biometrics industry with a maximum of 50,000 facial templates, facial recognition speed less than 0.3 sec per face, ultimate anti-spoof ability against almost all types of fake photos and videos attack. ProFace X comes with a robust design that can work in extreme weather conditions from -30°C to 60°C; The IP68 dust and waterproof standard and IK04 protection standard also enhance its outdoor durability.



Performance

In order to improve the efficiency of pedestrian access management and user experience, we adopted a new type of servomotor which makes the speed gates have faster opening speed and lower noise. The test results show that the opening speed is less than 1.2 seconds with the standard barrier instead, if assembled the mid-height barrier panels, the opening speed is less than 0.8 seconds. The infrared sensors has increased to 10 pairs, which is 160% more than other similar products in order to provide more accurate logical judgment.



Quality

Casing of the product is mostly made of superior SUS304 stainless steel for its remarkably high durability. The barrier panels are made of acrylic and have better aging resistance and impact resistance. From raw material procurement to production, a strict quality control and inspection system will be applied.



Features

- 0.3s high speed facial recognition
- Servomotor - faster opening speed
- 10 pairs of infrared sensors for stronger tailgate detection.
- SUS304 stainless casing
- Higher durability for longer product life cycle
- Easy switch, easy installation - RFID, fingerprint, face, etc.
- Bi-directional operation control
- LED passage indicator in both directions
- Convenient installation and maintenance
- Various optional panels
- Emergency mode allows free access when power failures or emergency



Specifications

Power requirements	AC 100 ~ 120V/200 ~ 240V, 50/60Hz
Working temperature	-28°C ~ 60°C
Working humidity	20%-95% (Non-condensing)
Working environment	Indoor
Speed of throughput	Maximum 40/ minute
Lane width(mm)	660
Footprint(mm*mm)	1600*1040
Dimensions(mm)	L=1600, W=1040, H=1200
Dimension with packing(mm)	L=1700, W=300, H=1130
Net weight(kg)	130kg
Weight with packing(kg)	150kg
Cabinet material	SUS304 Stainless Steel
Lid material	SUS304 Stainless Steel+Acrylic
Barrier material	Acrylic
Barrier movement	Swing
Emergency mode	Y
Faces capacity	30,000 (1:N) / 50,000 (Optional)
Compatibility	900 MHz Dual Core Customized CPU
	512MB RAM / 8G Flash
	8" High Brightness (400lux) IPS Touch LCD
	2MP WDR Low Light Camera
	IP68 & IK04
Dimensions of facial recognition device (H*L*D)	227mm*143mm*26mm

Optional panels

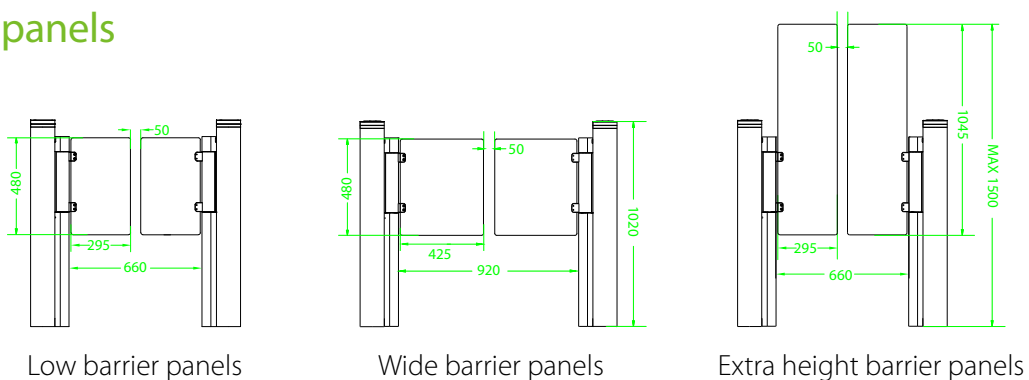

Dimensions (mm)

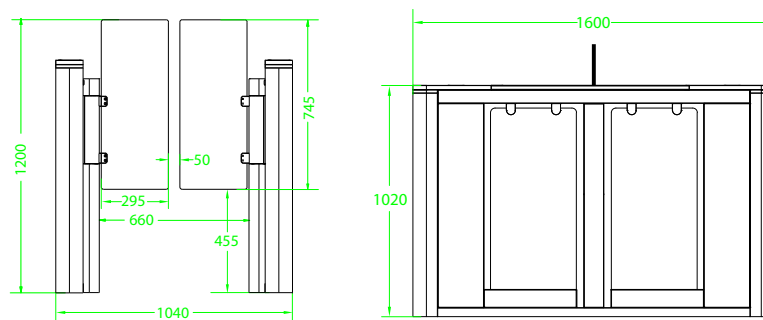

V1.1 2019.11.20

